

+ Shaped for performance

Confidence driven by reliability,
control driven by design

Smith+Nephew

PLATINUM
Handpiece



+ Confidence in the palm of your hand

Shaped for performance, the PLATINUM Handpiece from Smith+Nephew combines high torque¹ and speed¹ in a lightweight design.² It delivers the reliability you expect in a shaver handpiece with a design⁵ that helps put you in control of the procedure.⁶

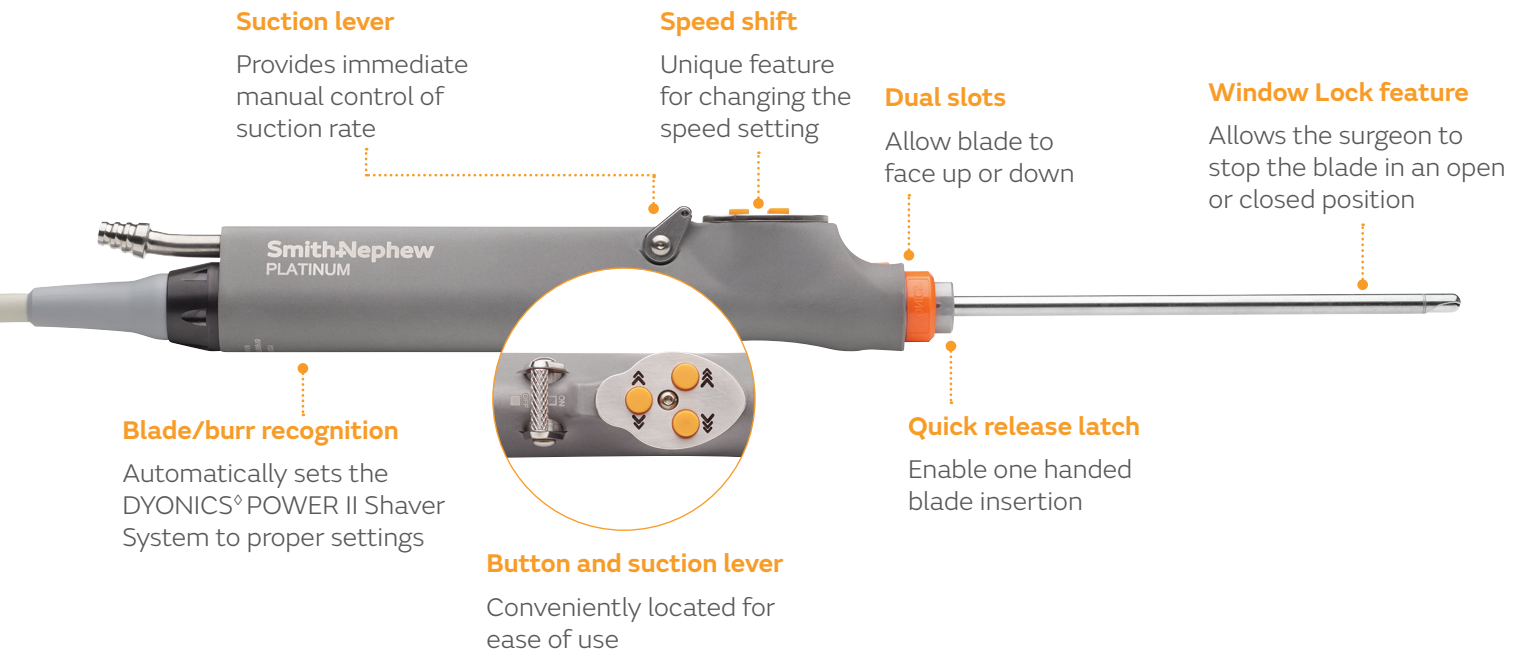

+ The PLATINUM Handpiece offers:

- **Greater torque** than the DYONICS[®] POWERMAX[®] ELITE, between the typical forward mode working range^{1**}
- **Less vibration** than leading competitors at maximum speed settings⁴
 - **26% less vibration** (RMS) on average than the Arthrex APS II
 - **64% less vibration** (RMS) on average than the Conmed Ergo
- **Weighs less** than the Arthrex APS II handpiece²



Reliable

Improved reliability compared to the DYONICS POWERMAX ELITE⁵, intended to increase the longevity of S+N handpieces



Ergonomic

Improved ergonomic handle compared to competitive handpieces^{6***}



Performance

Significantly greater soft tissue resection performance compared to the DYONICS POWERMAX ELITE^{3*}

+ Choose your grip

The PLATINUM Handpiece is designed to accommodate multiple grip styles for surgeon preference and comfort.⁷



+ Performance and features driving confidence, usability and control

The PLATINUM Handpiece is designed to work with the DYONICS[®] POWER II Control System, taking powered resection to a new level.



Blades: comprehensive portfolio + superior efficiency^{8,9****}

The PLATINUM Handpiece is fully compatible with our extensive line of DYONICS straight blades, curved blades, BONECUTTER[®] blades and burrs.



Ordering information

PLATINUM Handpiece	
Reference #	Description
72205321	PLATINUM Handpiece
72200873	DYONICS [®] POWER II Shaver System Control Unit (Control Unit only). All units 100-240 VAC, 50/60 Hz
72201092	DYONICS POWER II Footswitch

*As demonstrated using a 4.5mm DYONICS PLATINUM Bonecutter, $p \leq 0.05$

** Working range of 4,000-10,000 rpm

*** As compared to Arthrex™ APS II, Conmed Ergo™, and Stryker™ Formula™ CORE™

****As demonstrated ex vivo at maximum settings vs competitive blades

Products may not be available in all markets because product availability is subject to the regulatory and/or medical practices in individual markets. Please contact your Smith+Nephew representative or distributor if you have questions about the availability of Smith+Nephew products in your area.

Learn more at [smith-nephew.com](https://www.smith-nephew.com)

Smith & Nephew, Inc.
150 Minuteman Road
Andover, MA 01810

www.smith-nephew.com
T +978 749 1000
US Customer Service:
+1 800 343 5717

[®]Trademark of Smith+Nephew.
All trademarks acknowledged.
©2023 Smith+Nephew. All rights reserved. 34065 V2 05/23

References

1. Smith+Nephew 2021. Protocol, Claims, PLATINUM MDU - Torque. Internal Report. 15011440 Rev A. **2.** Smith+Nephew 2021. Weight Testing, PLATINUM Handpiece. Internal Report. 15011407 Rev A. **3.** Smith+Nephew. Protocol, Claims, PLATINUM MDU - Resection Rate. Internal Report. 15011370 Rev A. **4.** Smith+Nephew 2021. Protocol, Competitive, PLATINUM MDU - Vibration. Internal Report. 15011369 Rev A. **5.** Smith+Nephew 2021. Reliability Testing, PLATINUM Handpiece. Internal Report. 15011406 Rev A. **6.** Smith+Nephew 2021. Ergonomics Testing, PLATINUM Handpiece. Internal Report. 15011373 Rev A. **7.** Smith+Nephew 2021. Design Validation Testing, PLATINUM Handpiece. Internal Report. 15011313 Rev A. **8.** Smith+Nephew 2019. Competitive Testing, 3.5 mm Platinum Blades. Internal Report. 15007992 Rev A. **9.** Smith+Nephew 2018. Competitive Testing, 4.5 mm Curved Platinum. Internal Report. 15007991 Rev A.